

# TECHNICAL DETAILS

## Apex Stone - Textured

### PRODUCT DRAWINGS

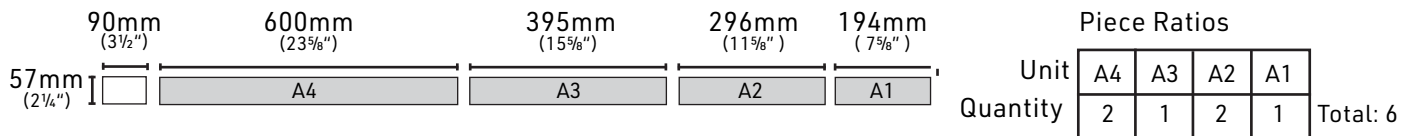
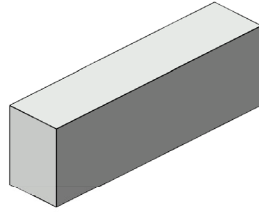

### PRODUCT DETAILS

	Metric	Imperial
Selling UoM		SF
Units/Skid	8.7m <sup>2</sup>	94sf
Weight/UoM	151.7kg	31.00lbs
Weight/Piece	N/A	N/A
Weight/Skid	1,343kg	2,954lbs
Pieces/Skid	N/A	N/A
# of Layers	10	10
Pieces/Layer	N/A	N/A
UoM/Layer	0.87m <sup>2</sup>	9.4sf
Pieces/UoM	N/A	N/A
Pallet Size	101cmx119cm	40"x48"

## CORNERS

Corners are included  
100% of the units are corners

## TYPICAL INSTALLATION PATTERN

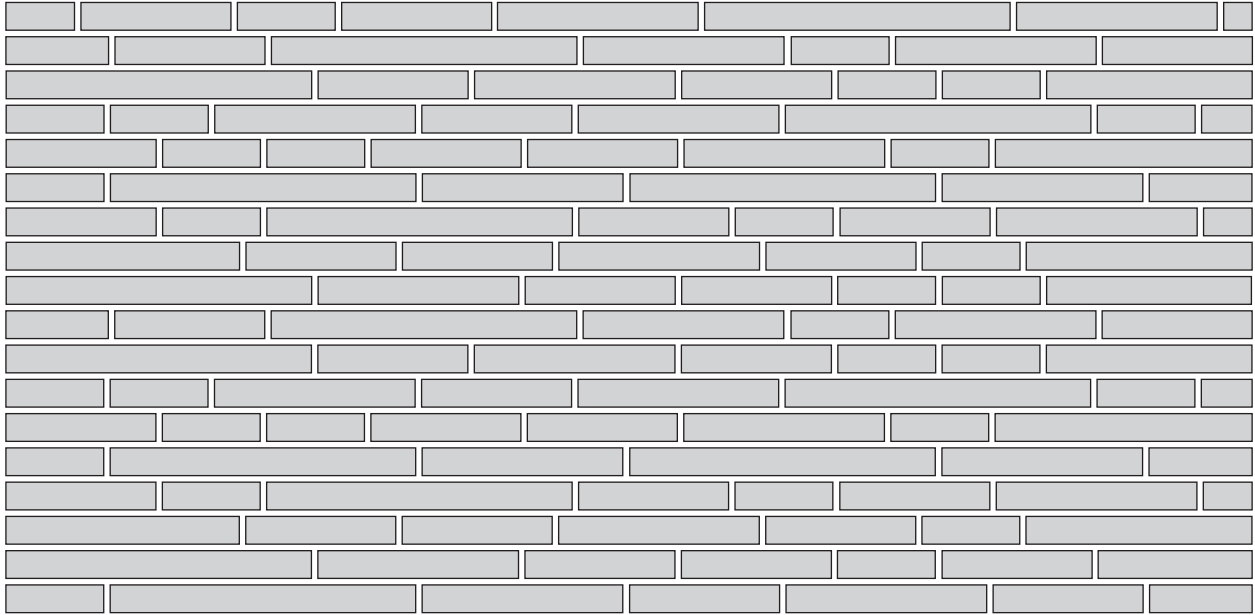

Typical Installation Guidelines: • Blend product from multiple packages for most natural look

## TYPICAL MORTAR JOINT

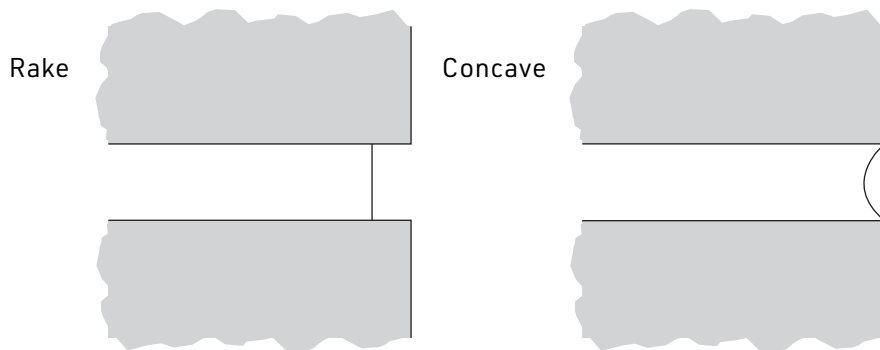

Recommended Mortar Joint 10mm (3/8")

## TYPICAL COURSING GUIDE

Table includes one unit and one joint.

Vertical Units	10mm Joint	3/8" Joint
1	67mm	2 <sup>5</sup> / <sub>8</sub> "
2	134mm	5 <sup>1</sup> / <sub>4</sub> "
3	201mm	7 <sup>7</sup> / <sub>8</sub> "
4	268mm	10 <sup>1</sup> / <sub>2</sub> "
5	335mm	13 <sup>1</sup> / <sub>8</sub> "
6	402mm	15 <sup>3</sup> / <sub>4</sub> "
7	469mm	18 <sup>3</sup> / <sub>8</sub> "
8	536mm	21"
9	603mm	23 <sup>5</sup> / <sub>8</sub> "
10	670mm	26 <sup>1</sup> / <sub>4</sub> "
20	1,340mm	52 <sup>1</sup> / <sub>2</sub> "
30	2,010mm	78 <sup>3</sup> / <sub>4</sub> "
40	2,680mm	105"
50	3,350mm	131 <sup>1</sup> / <sub>4</sub> "
100	6,700mm	262 <sup>1</sup> / <sub>2</sub> "

## CODES & STANDARDS

Shouldice Stone Products are supported by the following National Codes & Standards. Refer to local building codes and standards to confirm best practice.

### CANADIAN

CSA A165 Standards on Concrete Masonry Units  
 CSA A371 Masonry Construction for Buildings  
 CSA A179 Mortar and Grout for Unit Masonry  
 CSA A370 Connectors for Masonry

### AMERICAN

ASTM C55 Specification for Concrete Building Brick  
 ASTM C90 Specification for Loadbearing Concrete Masonry Units  
 ASTM C270 Specification for Mortar for Unit Masonry  
 ASTM C476 Specification for Grout for Masonry  
 ASTM C1634 Specification for Concrete Facing Brick and Other Concrete Masonry Facing Units

NCMA TEK 8-4A Cleaning Concrete Masonry  
 NCMA TEK 9-1A Mortars for Concrete Masonry  
 NCMA TEK 8-3A Control and Removal of Efflorescence  
 NCMA TEK 10-4 Crack Control for Concrete Brick and other Concrete Masonry Veneers  
 NCMA TEK 19-5A Flashing Details for Concrete Masonry Walls

## TYPICAL UNIT PROPERTIES

Products exceed the CSA and ASTM standards.

	Standard	Compressive Strength	Absorption	Density	Fire Rate (Hours)
CSA	A165.2	>25mpa	<8%	>2000kg/m <sup>2</sup>	1.1
ASTM	C1634	>3000psi	<12lb/ft <sup>3</sup>	>125lb/ft <sup>3</sup>	

## HATCH PATTERNS & TEXTURE MAPS

To access Shouldice Stone Hatch Patterns and texture maps visit the corresponding [shouldice.ca product page](#) for current availability.

## CONTACT US

For technical questions regarding our product line please contact our knowledgeable customer service team. By phone: **800.265.3174** or email: [designer@shouldice.ca](mailto:designer@shouldice.ca)