



**SHOULDICE
STONE**

TECHNICAL DETAILS

90x190x390 Tapestry Stretcher

PRODUCT DRAWINGS

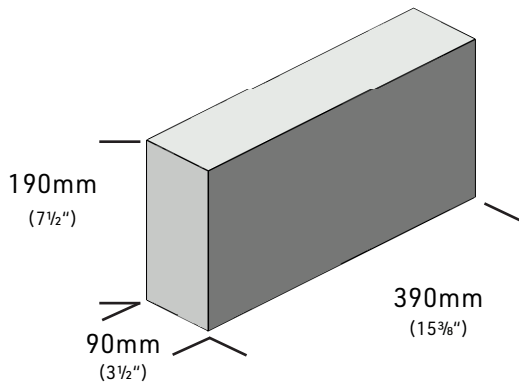

PRODUCT DETAILS

	90x190x390 Tapestry Stretcher		90x190x390 Tapestry Corner		90x190x390x190 Tapestry L Corner	
	Metric	Imperial	Metric	Imperial	Metric	Imperial
Selling UoM		EA		EA		EA
Units/Skid	90EA	90EA	90EA	90EA	60EA	60EA
Weight/Each	14.26kg	31.89lbs	14.26kg	31.89lbs	18.26kg	40.89lbs
Weight/Skid	1381kg	3038lbs	1381kg	3038lbs	1181kg	2538lbs
# of Layers	3	3	3	3	3	3
Pieces/Layer	30	30	30	30	20	20
Coverage/Unit	0.083m ²	0.89sf	0.083m ²	0.89sf	0.123m ²	1.39sf
Coverage/Skid	7.47m ²	80.1sf	7.47m ²	80.1sf	8.47m ²	90.1sf
Linear Unit/Piece	N/A	N/A	0.20m	0.76'	0.20m	0.76'
Pallet Size	101cmx119cm	40"x47"	101cmx119cm	40"x47"	101cmx119cm	40"x47"

CORNERS

Corner units are sold separately.

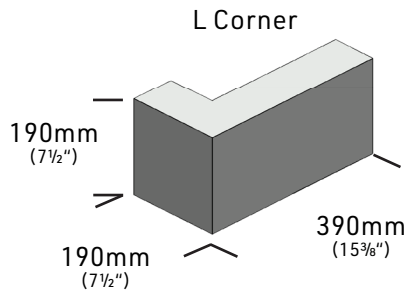
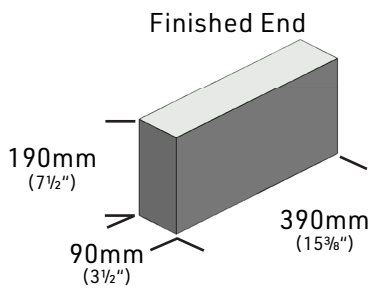

TYPICAL INSTALLATION PATTERN

Running Bond

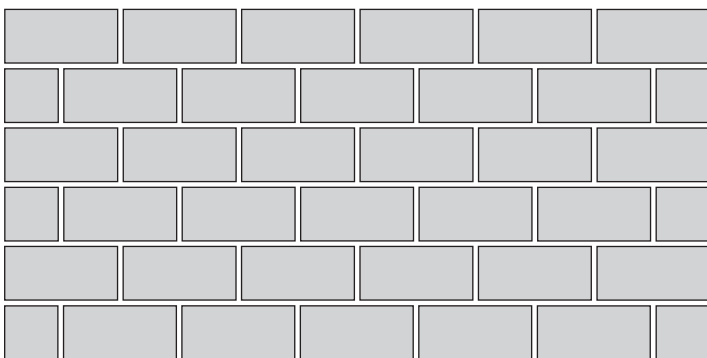

Stack Bond

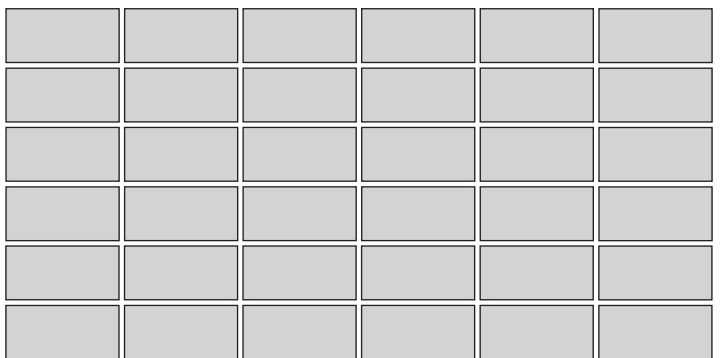

Typical Installation Guidelines: • Blend product from multiple packages for most natural look

TYPICAL MORTAR JOINT

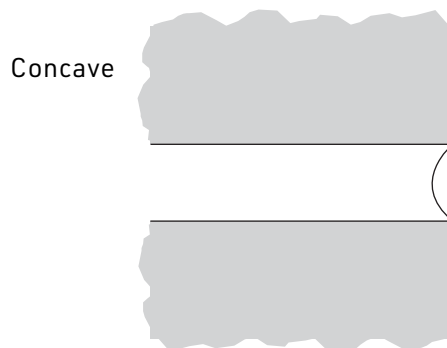
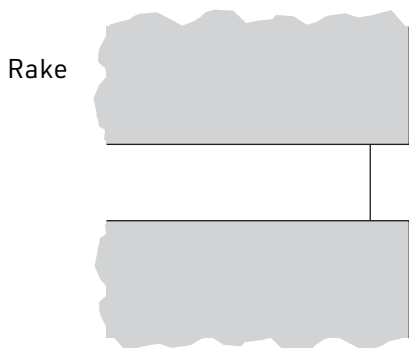

Recommended Mortar Joint 10mm (3/8")

PRODUCT OPTIONS

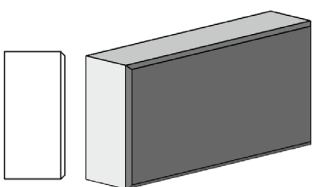

Bevel
10mm
(3/8")

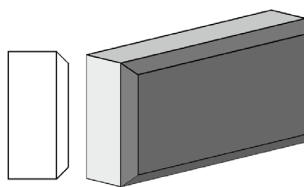

Bevel
25mm
(1")

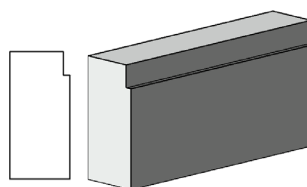

Margin Cut
10mm x 35mm
(3/8" x 1 3/8")

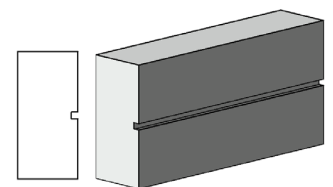

Horizontal Score
10mm x 10mm
(3/8" x 3/8")

TYPICAL COURSING GUIDE

Tables Include one unit and one joint.

Vertical Units	10mm Joint	3/8" Joint	Horizontal Units	10mm Joint	3/8" Joint
1	200mm	7 7/8"	1	400mm	15 3/4"
2	400mm	15 3/4"	2	800mm	31 1/2"
3	600mm	23 5/8"	3	1,200mm	47 1/8"
4	800mm	31 1/2"	4	1,600mm	63"
5	1,000mm	39 3/8"	5	2,000mm	78 5/8"
6	1,200mm	47 1/4"	6	2,400mm	94 3/8"
7	1,400mm	55 1/8"	7	2,800mm	110 1/8"
8	1,600mm	63"	8	3,200mm	125 7/8"
9	1,800mm	70 7/8"	9	3,600mm	141 1/2"
10	2,000mm	78 3/4"	10	4,000mm	157.29"
20	4,000mm	157 1/2"	20	8,000mm	314 1/2"
30	6,000mm	236 1/4"	30	12,000mm	471 7/8"
40	8,000mm	315"	40	16,000mm	629 1/4"
50	10,000mm	393 3/4"	50	20,000mm	786 1/2"
100	20,000mm	787 1/2"	100	40,000mm	1,573"

CODES & STANDARDS

Shouldice Stone Products are supported by the following National Codes & Standards. Refer to local building codes and standards to confirm best practice.

CANADIAN

[CSA A165 Standards on Concrete Masonry Units](#)

[CSA A371 Masonry Construction for Buildings](#)

[CSA A179 Mortar and Grout for Unit Masonry](#)

[CSA A370 Connectors for Masonry](#)

AMERICAN

[ASTM C55 Specification for Concrete Building Brick](#)

[ASTM C90 Specification for Loadbearing Concrete Masonry Units](#)

[ASTM C270 Specification for Mortar for Unit Masonry](#)

[ASTM C476 Specification for Grout for Masonry](#)

[ASTM C1634 Specification for Concrete Facing Brick and Other Concrete Masonry Facing Units](#)

[NCMA TEK 8-4A Cleaning Concrete Masonry](#)

[NCMA TEK 9-1A Mortars for Concrete Masonry](#)

[NCMA TEK 8-3A Control and Removal of Efflorescence](#)

[NCMA TEK 10-4 Crack Control for Concrete Brick and other Concrete Masonry Veneers](#)

[NCMA TEK 19-5A Flashing Details for Concrete Masonry Walls](#)

TYPICAL UNIT PROPERTIES

Products exceed the CSA and ASTM standards.

	Standard	Compression Strength	Absorption	Density	Fire Rate (Hours)
CSA	A165.1	>15mpa	<8%	>2000kg/m ²	1.4
ASTM	C1634	>3000psi	<12lb/ft ³	>125lb/ft ³	

HATCH PATTERNS & TEXTURE MAPS

To access Shouldice Stone Hatch Patterns and texture maps visit the corresponding [shouldice.ca](https://www.shouldice.ca) [product page](#) for current availability.

CONTACT US

For technical questions regarding our product line please contact our knowledgeable customer service team. By phone: **800.265.3174** or email: **designer@shouldice.ca**